

This drawing is the property of Tusonix, Inc., and may not be used, reproduced, published or disclosed to others without expressed authorization by Tusonix Inc.

MARKETING SALES DRAWING
DIMENSIONS IN INCHES - DO NOT SCALE THIS DRAWING
DIMENSIONS IN METRIC - []

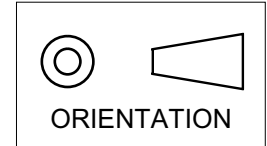

Electrical Testing
per Tusonix standard
test plans and Mil-Std-202
Test Methods.

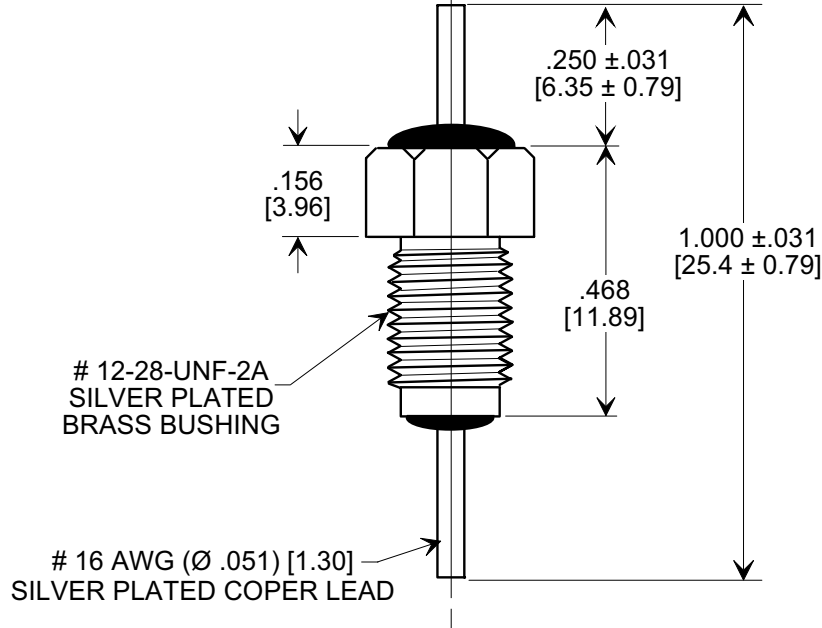
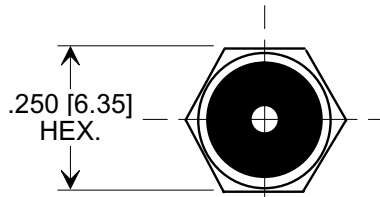

SPECIFICATIONS

TUSONIX STYLE:	2499-508
CAP. VALUE	1000 pF
CAP. TOL.	±20%
TEMP. CHARACTERISTICS:	X5S
CURRENT:	20 A
RATING:	250 VAC, 0 TO 400 Hz
OPERATING RANGE:	-55 TO +85°C
DWV:	1200 VAC, 60 Hz, 2 SEC.
I.R. MIN. @ 100 (VDC)	10 G Ω

NOTES:

- SUPPLIED WITH SILVER PLATED HEX NUT AND INTERNAL TOOTH LOCK WASHER.
- TUSONIX STANDARD PART
 NUMBER: 2499-508-X5S0-102M.
 TUSONIX R.o.H.S. COMPLIANT PART
 NUMBER: 2499-508-X5S0-102M LF.
 CUSTOMER MUST SPECIFY STANDARD OR RoHS PART NUMBER WHEN ORDERING.
- PART MARKING: TRADEMARK, CAPACITANCE CODE AND TOLERANCE CODE STAMPED ON BUSHING HEX FLATS:
 STANDARD PART: BLACK MARKING.
 RoHS COMPLIANT PART: GREEN MARKING.

X-2015 Rev-0

REVISION RECORD

Original Release C.O.	
WAS SK 8038-075 L.E. 05-13-03	
20030509-1-04	0
ADDED & REVISED NOTES. ADDED I.R. S.M. 07-28-06	
20060712-6-08	1

--TOLERANCES--
 Unless Otherwise Specified

DECIMAL ± .015 [0.38]

ANGLES ±

TUSONIX
 TUCSON, ARIZONA

Title **BUSHING STYLE
 FEED-THRU
 CAPACITOR**

Drawn S.M. 04-24-03 Scale 3 X

Approved T.C. 04-24-03

A 2499-508-X5S0-102M